

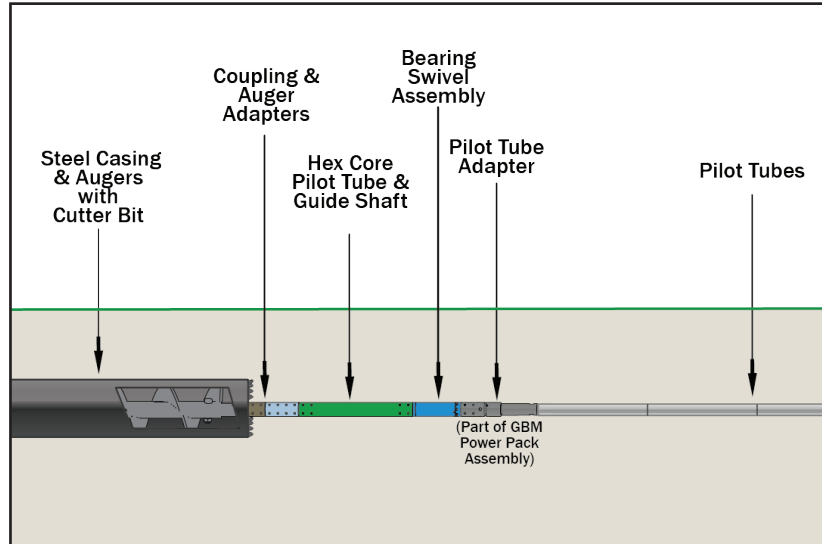

GBM Bearing Swivel Auger Pullback Assembly, Inspection and Lubrication FA48949F, FA49335F Instruction Part No. 050133A

The **Bearing Swivel Assembly FA48949F** is a tool used between the **Pilot Tube Adapter***, **FA41403F**, and the Akkerman or other auger boring machine cutter bit. It keeps the pilot tube string stationary while absorbing the rotation of the augers as they remove spoils from the pipeline. The Bearing Swivel Assembly is designed to install up to 24 in. OD steel casing and withstand up to 50 tons of thrust capacity, typically presented in stiff or difficult ground conditions without rocks.



A common use of the Bearing Swivel Assembly is when the contractor must pull back the augers to expose the cutter bit to remove an obstacle. The **Auger Pullback Assembly, FA49335F**, allows the contractor to retract the cutter bit and augers through the pipeline, remove the obstacle, reconnect them to the pilot tube string, and maintain line and grade.

* The Pilot Tube Adapter is part of the GBM Power Pack Assembly.

AUGER PULLBACK ASSEMBLY PARTS NUMBERS

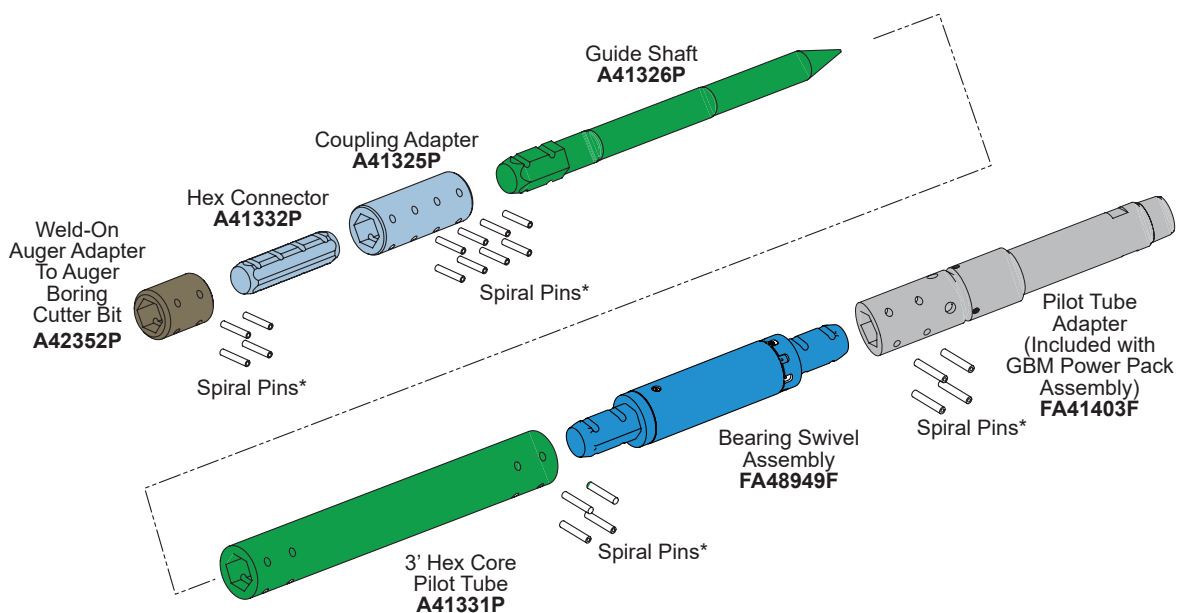

* Qty. (20) Spiral Pins, **P0049-201**

GBM BEARING SWIVEL INSPECTION AND LUBRICATION

Regular inspection and maintenance on the GBM bearing swivel is critical for reducing downtime from bearing swivel failure.

BEFORE EACH DRIVE the Bearing Swivel Assembly MUST be properly lubricated and inspected for contamination and end play. Failure to do so may cause swivel failure.

⚠ WARNING The Bearing Swivel Assembly is heavy. Use proper lifting device while handling the swivel assembly.

1. Carefully place the Bearing Swivel Assembly on a chain vise. Orient the check plug (A) so it is located at the top 12 o'clock position. With chain on mid body (B) of the swivel assembly, secure with vise.
2. Clean areas around the check plug (A) and fill plug (C).
3. Remove fill plug P0300-026 (C) from coupling (D). Retain plug for reinstallation after lubricating swivel.
4. Install grease fitting (not shown) into fill plug (C) threaded hole on coupling.
5. Remove check plug P0300-682 (A).
6. Load grease gun with Paragon® 3000 grease or equivalent.
7. Gain access to grease fitting.
8. Connect grease gun to grease fitting.
9. Pump grease while rotating the swivel until grease is purged out of check plug port (A). Check purged grease for any signs of contamination. If there are signs of contamination, contact Akkerman Aftermarket Support for more information.
10. Remove grease gun.
11. Remove grease fitting.
12. Replace fill plug (A) and check plug (B).
13. Inspect bearing assembly for end play. Grasp the coupler (coupler by the check plug as shown). Shake the coupler side to side, up and down. If there is any movement, the bearings may require inspection. Contact Akkerman Aftermarket Support for more information.

NOTICE As additional grease is pumped into the swivel, more resistance may be felt while rotating the swivel. This is normal.

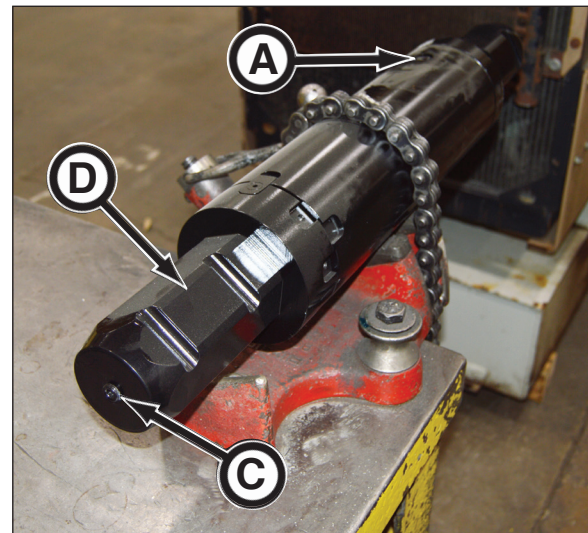
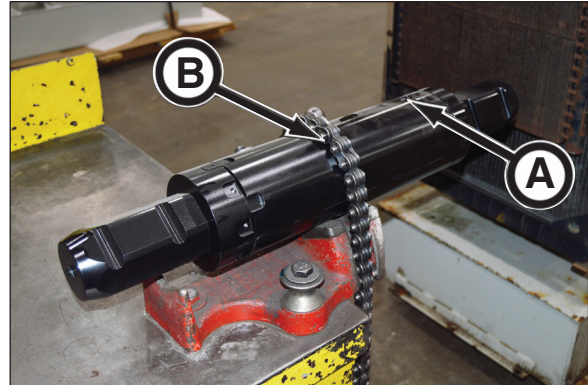

Inspecting Bearing Swivel Assembly For End Play